

2017 AIA Northwest and Pacific Region Firm Award



MITHÜN

DESIGN DEEPLY ROOTED IN PLACE—

Mithun's designs emerge from an understanding of the specific qualities and needs of the landscapes and communities within which we work.

Practicing in the Pacific Northwest since 1949, Mithun has been widely recognized as a significant contributor to a contemporary northwest aesthetic. With a regional design ethos deeply rooted in place, our firm is known for site sensitive design, clear tectonic expression and innovative use of authentic and natural materials.

Our design process honors the identity of places—culture, history and ecology—with a reverence for the characteristics that make each unique. We take special pride in collaborating with clients and communities to craft places that celebrate culture and ecology, serve diverse peoples and advance future generations.

Over recent decades, as our practice has grown with increased national commissions, these same design values have inspired place-based design in a wide range of settings from Yosemite National Park to New Orleans, to the mountains of Jackson Hole and the Sonoran Desert.

Celebration of Craft and Place >

Novelty Hill's destination winery celebrates the art and science of winemaking as well as wine's agrarian roots. Building and landscape work in harmony to reveal the production process and remind visitors of the inextricable link between wine and earth. Mithun's integrated design won an AIA Institute Honor Award for Interior Architecture and the International Interior Design Association (IIDA) Interior Design Award.

Scroll down to read more ▼





Serving Human and Natural Ecologies ▲

The **Federal Way Regional Library** renovation and addition expands capacity and strengthens connections with the forested site and growing community. New reading rooms holding the library's diverse collections are housed within a series of glass and steel pavilions that engage the forest. The sculptural pavilions are positioned to preserve mature evergreens, and open to views of trees, rain gardens and native plantings.

Iconic Place-based Design >

Clockwise from top left: **Wanapum Heritage Center** reaffirms the living Wanapum culture and history on the Columbia River. The design of **Miraval Resort and Spa** in Tucson, Arizona, combines the desert's rich human history with environmentally intelligent practices to enrich the award-winning spa experience. The new campus for **Teton Science Schools** in Jackson Hole, Wyoming, fuses the K-12 Journeys School with an immersive residential environmental education program. Inspired by the underlying geology of the site, the buildings' sloping roof forms optimize daylight, natural ventilation and views of adjacent native habitats.



SWEEPING VIEWS TO THE SOUTH AND EAST CONNECT THE CATALINA MOUNTAINS TO MIRAVAL'S CAMPUS AND ESTABLISH ITS CHARACTER AS A PLACE FOR CONTEMPLATION AND HEALING. ELEVATION, HABITAT AND NATURAL HYDROLOGY COMBINE TO BLUR THE CAMPUS EDGE WITH THE DIVERSITY OF THE GREATER LANDSCAPE.

TRAILBLAZING ECOLOGICAL DESIGN AT ALL SCALES—

Mithun has been nationally recognized for design excellence with six AIA COTE Top Ten Awards for groundbreaking projects in diverse typologies.

Mithun's body of work expands connections and pursues opportunities beyond property lines and zoning envelopes—from human health and social cohesion to low impact development, district energy, water systems and transportation strategies. We have positively reshaped communities and advanced design excellence through work ranging in scale from cabin to campus to city. Examples include the compact but influential Sustainability Treehouse, campus sustainability plans for carbon neutral operations at the Ohio State and Seattle Universities and the 2008 Puget Sound Reality Check's workshop-based carbon impact assessment for regional growth.

Mithun is consistently at the forefront of integrated green and health initiatives like AIA Design + Health, and served as an initial signatory to multiple groundbreaking initiatives including Architecture 2030, SITES, USGBC LEED ND rating system and ULI Climate, Energy and Land Use initiative.

Our staff have also contributed to numerous independent academic and professional publications. In 2008, we published **Integrated Design**, detailing Mithun's replicable design approach and sharing notable project precedents and integrative technical strategies.

Net Positive Campus Development >

A 2017 AIA COTE Top Ten project, **Chatham University's Eden Hall Campus** is designed to generate more energy than it uses, is a water resource, produces food, recycles nutrients, and supports habitat and healthy soils while developing the next generation of environmental stewards.

Scroll down to read more ▼



6 AIA COTE TOP TEN GREEN AWARDS

10+ NET ZERO BUILDINGS

AIA 2030 COMMITMENT

3 LIVING BUILDING TARGETED BUILDINGS

150+ GREEN STORMWATER PROJECTS

40+ LEED CERTIFIED PROJECTS

15+ PROJECTS WITH GREEN DISTRICT SCALE SYSTEMS

500+ SUSTAINABLE DESIGN PRESENTATIONS

CARBON NEUTRAL OPERATIONS SINCE 2004



A Living Building in the Trees ▲

The net zero energy and net zero water **Sustainability Treehouse** reveals the implication of daily resource use through interactive building systems—photovoltaic panels, wind turbines, and a water collection and filtration system. At each step, it captures the wonder of childhood adventure and challenges visitors to apply meaningful stewardship ideals in their own lives.



Road Map for Sustainable Cities ▲

Mithun shapes cities through ecologically balanced, community-focused planning and urban design. The **Lloyd Crossing Sustainable Urban Design Plan** promoted sustainable transformation at the district and neighborhood scale, inspired the EcoDistricts movement and was the first non-building project recognized with an AIA COTE Top Ten Award.



< Share Openly

Our open source approach to research and design ensures that the results become tools for widespread use and positive impact. For example, Mithun created and continues to host **buildcarbonneutral.org**, a carbon calculator design tool developed to increase knowledge of the impact of embodied carbon on climate change. It is used nationwide as a design resource by professionals and programs including the annual AIA COTE Top Ten Award project calculations.

ADVOCACY AND COMMUNITY SERVICE—

Reaching beyond project boundaries, Mithun creates opportunities to advance public good and promote healthy community transformation.

We give big, through time and contributions, to the communities where we live and work. Our leaders are actively involved with many civic institutions, and we encourage all staff to engage in professional and community service that aligns with their passions.

Professional Advocacy

Mithun leaders have served on AIA Seattle and AIA San Francisco boards of directors, as past AIA Seattle chapter presidents (four times), Honor Awards co-chair, and other positions. Nationally, firm members serve on the AIA Design and Health Leadership Group, AIA Interior Architecture Knowledge Community Advisory Group and AIA Documents Committee, and previously as GSA Design Excellence peer reviewers and National Architectural Accreditation Board past president.

Reflecting Mithun's interdisciplinary practice, staff have also led diverse organizations and initiatives: as founding board member of EcoDistricts, as vice chair of the USGBC core committee to develop the LEED ND rating system, as a founder of CNU, on the board of the Landscape Architecture Foundation, as an advisor to the National Building Museum's Intelligent Cities Initiative, and on of SITES Steering and Technical Committees and multiple ULI leadership committees.

Civic Engagement

Our firm leaders serve on the boards of major civic institutions and non-profit organizations—Forterra, IslandWood, Woodland Park Zoo and San Francisco Housing Action Coalition, among others—working to advance livable cities, environment, education and culture. Mithun contributes generously in time and donations to local institutions and community-based organizations. We hosted the first city-wide design charrette to envision a new Seattle Waterfront, helped establish the Washington Clean Tech Alliance and served on founding boards of the USGBC Cascadia, as well as the Seattle Climate Partnership.

In fact, Mithun has given more than \$2 million in donations and in-kind services to Pacific Northwest organizations during the past 10 years alone. Our culture of service and commitment to social justice is evident at all levels of the organization. Pro bono projects and volunteer initiatives apply expertise and elbow grease to critical civic and environmental issues like new affordable housing models, tiny house village planning for the homeless, and environmental education for urban youth. Our entrepreneurial activism is a model for architectural practices, and performance is transparently reported via the International Living Future Institute JUST program to inspire and inform other organizations.

Scroll down to read more ▼

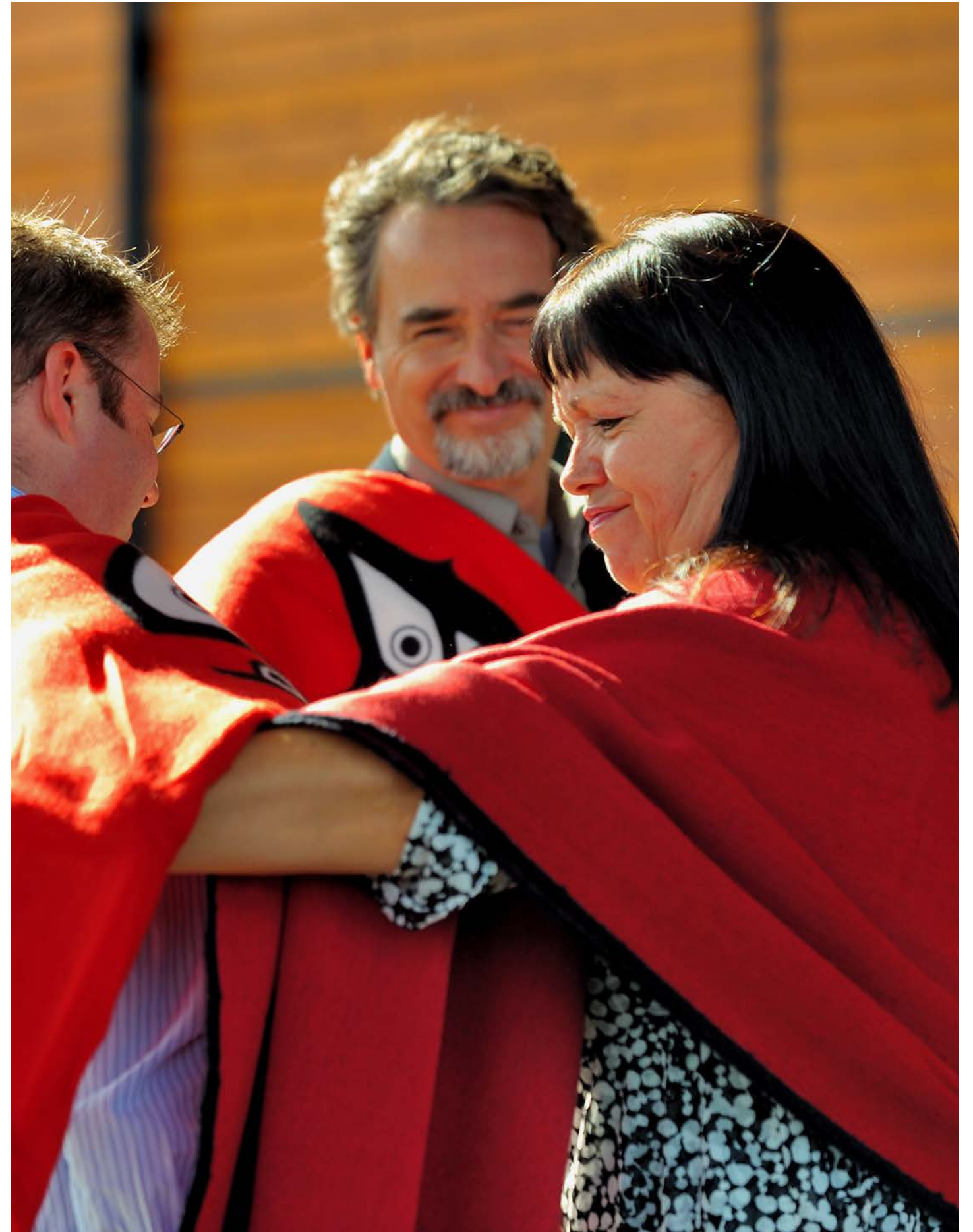

MITHUN HAS GIVEN MORE THAN \$2 MILLION IN DONATIONS
AND IN-KIND SERVICES TO PACIFIC NORTHWEST
ORGANIZATIONS DURING THE PAST 10 YEARS ALONE.

Georgetown Tiny House Village

Housing affordability has become a critical issue within communities across the nation, and homelessness is at the front and center of our minds. With approximately 11,000 individuals experiencing homelessness in the Seattle area, many at Mithun have been striving to help address this issue. Through the initiative and volunteer efforts of our staff, Mithun has been providing pro bono conceptual planning services to the **Low Income Housing Institute (LIHI)** for a tiny house village in Seattle’s Georgetown neighborhood. We have also designed supportive housing for formerly homeless families, seniors and individuals in San Francisco.

Supporting Sustainability at the District Scale

Mithun is a founding member of **EcoDistricts**, a nonprofit organization that assists cities, nonprofits and the private sector to build equitable, resilient and sustainable neighborhoods. Our staff have provided training to the industry as a faculty member of the EcoDistricts Institute, as well as speaking at the EcoDistricts Summit annual conference. Additionally, Mithun has provided in-kind services to develop the EcoDistricts Global Protocol.

Fighting Summertime Hunger

For the past five years, Mithun has participated in Food Frenzy, a creative fundraising competition to combat childhood hunger. For two weeks in the summer, Mithun holds various fundraising events with all proceeds benefitting **Food Lifeline**. Staff also contribute to this great cause by spending a few fun and rewarding hours sorting and packing large quantities of food at Food Lifeline’s food packing warehouse.

Carbon Neutral Operations

Since 2004, Mithun has offset greenhouse gas emissions as an Associate Member of the Chicago Climate Exchange. Mithun is a founding member of the Seattle Climate Partnership, and in 2014, we signed the BICEP Climate Declaration as well as the Washington Business Climate Declaration.

Advocates for the Arts

Mithun’s commitment to public art is evident in its annual support of the **ArtsFund** campaign and service on the Seattle Arts Commission and Public Art Advisory Committee.

Annual Giving Campaign

In 2016, Mithun raised nearly \$14,000 during our annual **United Way of King County** giving campaign. Each fall, Mithun runs a campaign to support the most vulnerable members of our community. Mithun consistently boasts high levels of participation, with pledges from more than 50% of our staff. Our annual United Way giving campaign is yet another opportunity for Mithun to give back to our community and is a clear expression of our ethic to foster positive change.

A Day of Service for the Earth

Mithun joins the **Seattle Rotary** annually to celebrate Earth Day with a day of service at different parks around the city. We get our hands dirty by planting, mulching, removing invasive species and maintaining trails. It is an inspiring way to give back to Seattle’s public lands and help maintain and restore our cities most treasured spaces.

Sustainable SITES

The **Sustainable Sites Initiative®** (SITES) is an interdisciplinary effort by the American Society of Landscape Architects, the Lady Bird Johnson Wildflower Center at The University of Texas at Austin and the United States Botanic Garden to create voluntary national guidelines and performance benchmarks for sustainable land design, construction and maintenance. Mithun has been involved in the development of the tool and helped refine the tool with two SITES pilot projects, Louisiana Children’s Museum at City Park and Chatham University Eden Hall Campus.



EXPERIMENTATION AND INNOVATION—

Mithun transcends the traditional boundaries of practice and scale to address questions not yet asked.

We invest in research to solve clients' increasingly complex challenges, tackle global issues and advance the profession. Design, technology and policy converge to create places that improve how all people live.

Mithun leverages research initiatives and design competitions to expand knowledge and help define a better future. Our internal Research + Development grant program funds staff-proposed project-based research and sparks multidisciplinary experimentation. Similarly, our Design Analytics initiative expands understanding of real user behavior across all project types and sectors through a broad base of evaluation and interview tools..

We generously share lessons learned and invest in tools that advance national practice—including buildcarbonneutral.org, the first web-based materials carbon calculator; Greenhouse Gas Analysis methods used by ULI as a national template; urban planning guides utilized widely in academic settings; and theoretical design competitions that have advanced knowledge in ecological design and performance.

Architecture at Zero >

Mithun's net zero energy student housing design for the UC San Francisco Mission Bay campus received the top 2015 Architecture at Zero Honor Award. **ESTUARY** was developed in collaboration with PAE and features three residential structures enveloping a central terraced courtyard that connects residents as well as energy and water systems below. The community houses 750 students, and includes a café, childcare center, living machine and rooftop agriculture.

Scroll down to read more ▼





Calculating Embodied Carbon

The embodied energy of materials currently represents 20-35% of the life-cycle energy costs of a building, and this percentage is projected to increase to 60 or more as buildings approach their goal of net zero operational energy use. Our research team is currently investigating the use of life-cycle analysis to reduce embodied energy and emissions of materials, focusing on the impact of cross-laminated timber in comparison with Mithun's typical concrete and steel approach for multi-family and student housing project design. The effort incorporates data collection, workflow design and best practices, and will be developed into a training program for designers and application to other project types.

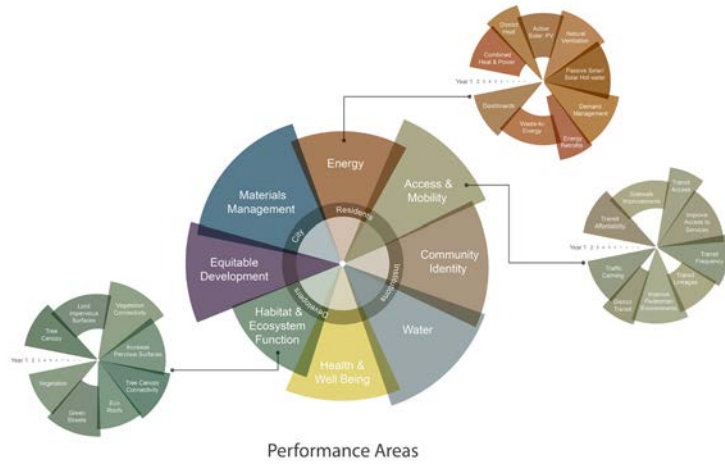

Empowering EcoDistricts

We began collaborating with **EcoDistricts** and Portland State University in 2010 to develop the beta EcoDistricts Assessment Toolkit to address sustainability at the district scale. Mithun collaborated in the development of the Assessment Process and tools such as the Project Palette and Performance Matrix. The Toolkit was beta tested in three Portland EcoDistricts, and became the basis for refined technical assistance tools that make up the EcoDistricts Initiative program today.

Contributing Leadership to LEED Rating Systems

Mithun helped to pioneer the LEED ND rating system. Bert Gregory served for five years on **US Green Building Council's** LEED ND Core Committee that developed the LEED ND rating system. Erin Christensen Ishizaki served for three years on the LEED Location and Planning TAG which handles planning and site issues across all LEED rating systems. In recognition of this work, Mithun received the USGBC Local/Regional Leadership award.

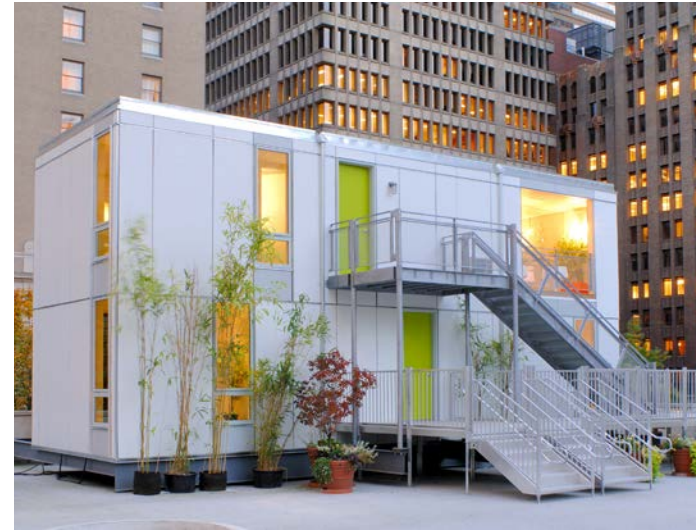

Building Smarter

Building cost-effective, quality housing is key to sustaining diverse and equitable urban communities. The **Inhabit** housing prototype explores the potential for modular construction to deliver high-quality, modern apartment living while saving time and reducing cost. Collaborating with engineers, contractors and financial modelers, Mithun developed concept studies to determine the feasibility of modular fabrication options compared with traditional on-site construction. A full scale mock-up was constructed in a prominent downtown Seattle location to test the physical prototype and solicit community feedback on innovative micro-unit designs. Since its completion, the project's success and widespread praise has engendered a series of built applications of various scales.



Design for Health

The **Mariposa Healthy Living Tool** is an evidence-based guide to integrate health into real estate. Mithun developed it for Denver's Mariposa Redevelopment where health is part of all decisions—from planning to property management. Using design thinking, Mithun translated public health research and methods into an accessible, integrated process for developers and designers to baseline indicators, prioritize, and implement project strategies for wellbeing. Today, the tool is an open source best practice published by Center for Active Design, Center for Disease Control, and U.S. Department of Housing and Urban Development (HUD).

Mithun is actively working with the **Green Health Partnership**—a collaboration between the US Green Building Council (USGBC) and University of Virginia School of Medicine, supported by the Robert Wood Johnson Foundation—to apply the LEED pilot credit to several affordable housing projects in California and to explore ways to increase systematic consideration of health within the design process.

CULTIVATING THE NEXT GENERATION—

Actively cultivating our fifth generation of firm leaders, Mithun's teams are structured to welcome ideas, reward collaboration and invite constant professional challenge.

Sharing Knowledge, Engaging Students

Mithun leaders maintain strong connections to the University of Washington as members of the College of Built Environments Professional Advisory Council, guest lecturers and past instructors. Our team has also participated in design education programs at Washington State University, University of Idaho and Montana State University, and as teachers and facilitators for the Leading is Learning workshop series, which embraces novel applications of design thinking to advance problem solving within K-12 curriculum. Through each contact, we share our expertise in design, placemaking, and community building, advancing the profession and multiplying the positive impact of our work.

Mithun also supports design education through efforts including the Mithun Endowed Design Fellowship and the Mithun/Russell Family Foundation Endowed Professor in Sustainability at the University of Washington College of Built Environments—the inaugural recipients of which were AIA Firm Award winners Stephen Kieran and James Timberlake.

Mithun team members generously share expertise and advance design discourse through presentations at annual conferences for diverse organizations—AIA, Greenbuild, Living Future, CNU, ASLA, ULI. Staff have also contributed to independent academic and professional publications including **Integrated Design**, detailing Mithun's replicable design approach and sharing notable project precedents and integrative technical strategies with peers.



Mithun/Russell Family Foundation Endowed Professorship in Sustainability at the University of Washington

Mithun and The Russell Family Foundation believe that the next opportunity for design innovation is to address the challenges confronting global systems. Through interdisciplinary collaboration, this endowed professorship brings science and design together to meet 21st century grand challenges such as climate change and urbanization, helping to shape our physical future in meaningful, healthful and elegant ways for mankind and the natural world. This position emphasizes the importance of design in providing leadership for such a future.

ACE Mentors

Mithun's commitment to supporting students interested in the engineering and design professions is reinforced by pro bono efforts and in-kind donations to the ACE Mentor Program. This volunteer program introduces high school students to architecture, design and engineering, and encourages them to pursue studies and careers in these fields. We believe that fostering the knowledge and professional development of today's youth will help to create a growing creative class of diverse individuals who will become tomorrow's industry leaders and represent the true makeup of our community.

Supporting Mithun's Emerging Professionals

Mithun is a great place to work, in part, because we view staff as our utmost strength and our greatest resource. Our culture of mentorship was started by our founder, Omer Mithun, a professor at the University of Washington. Now 68 years later, the spirit of Omer is carried forward in many ways including our thirst for learning, our commitment to education and our staff who generously "pull up a chair" to share their knowledge, guidance and encouragement with others around them. The firm's culture of mentorship is celebrated annually with the recognition of top "Mithun Mentors" nominated by staff.

To encourage ARE, LARE and NCIDQ completion, Mithun supports study groups, provides study materials and paid time off to take the exam, and offers a spot bonus upon successful completion of exams. Staff at all career stages benefit from Mithuniversity, an award-winning continuing education program, which includes courses and tours that advance our technical knowledge, encourage peer learning and sharing, and stimulate ideas.

Recognized with two national AIA Continuing Education Awards, Mithun's extensive professional development program includes dedicated time for research, a mentor for all developing designers and a six-month entry experience for new graduates in CoLAB—an interdisciplinary R+D think tank that explores new applications for advanced data-driven design.

Tech Talks

Every two weeks, an experienced and technically-oriented staff member leads a discussion on the design and constructability of a building component, such as guardrails, roof decks, thermal insulation and below-grade waterproofing. These talks are a small part of Mithun's larger mentorship and quality control program.

CoLAB

To drive innovation, Mithun's CoLAB offers the next generation of designers opportunity, mentorship and freedom from traditional constraints. This interdisciplinary think tank drives advanced data-driven design and research initiatives. Collaboration across disciplines is amplified to create, prototype and invent—not only in design, but in the very tools being used and the way Mithun works together. All staff may submit for a Mithun-sponsored R+D grant, focused on advancing projects through embedded research.

Mithuniversity and MIT

Mithuniversity is our professional development arm of continuing education. Firm members and industry professionals are invited to broaden our staff's knowledge through presentations, crit sessions, open debates and discourse. Topics range from design and technical presentation to project management, marketing and sustainability. Ultimately, the program keeps team members abreast of industry developments, creates better projects and fulfills AIA and USGBC continuing education units.

MIT focuses both on educating staff with technology and software resources available in the office, while also providing demos and hands-on training with the profession's latest innovations. Taught in collaboration by Mithun's staff experts and product specialists, classes focus on the practical parameters of design, maximizing project specific efficiency, maintaining graphic excellence and streamlining the iterative design process through graphic software. MIT's objective is to improve staff skill with Building Information Modeling (BIM), presentation graphics, design tools, collaboration software and practical office applications.



“FEED THE MIND AND THE SOUL OF THE EMPLOYEE, MITHUN BELIEVES, AND YOU FEED INNOVATION—AN INDISPENSABLE PART OF THE FIRM’S DESIGN APPROACH.”

–Architect Magazine